

Waverly Plantation Brazosport Archaeological Society

Waverly Plantation was located above Columbia on the east side of the Brazos River with acreage on both sides of Oyster Creek in the south western portion of the Stephen Richardson League. In 1848 Benjamin Goss of Brazoria County Texas and William Kennedy of Camden County South Carolina became half partners in 1476 acres or 1/3 of the Richardson League. While Kennedy's family remained in South Carolina William bought out Goss in 1854 and later increased his holdings in slaves and land by acquiring the Bolivar Tract in the William Harris League just south of the Waverly Plantation. The Bolivar Tract had been developed as a cotton plantation by Henry Austin during the colonial period and contained Bolivar Landing. The landing which was at the head of tidewater on the Brazos was a major shipping point on the Brazos for many planters in the area on the eastern side of the Brazos. Waverly was developed into a large scale cotton plantation before the Civil War. During the war Snow Hill the Kennedy family's plantation in South Carolina had been ruined. The sons of William Kennedy moved to Texas shortly after the war and the rest of the family shortly thereafter. The heirs of William Kennedy Sr. would maintain control until [redacted]. Portions of Waverly were acquired by the Texas Department of Corrections in [redacted] and became part of the Ramsey Unit operated as a prison farm.

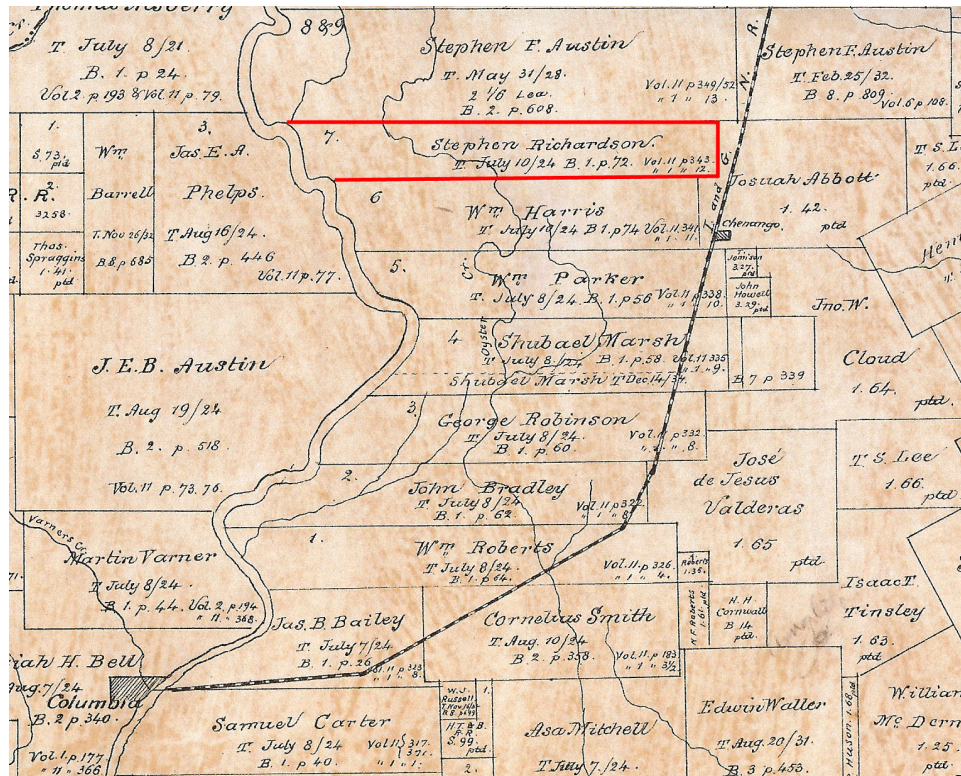

Stephen Richardson League Map 1879 The General Land Office of the State of Texas

